

ASSEMBLY INSTRUCTIONS

Workbench w/ Wood Work Surface

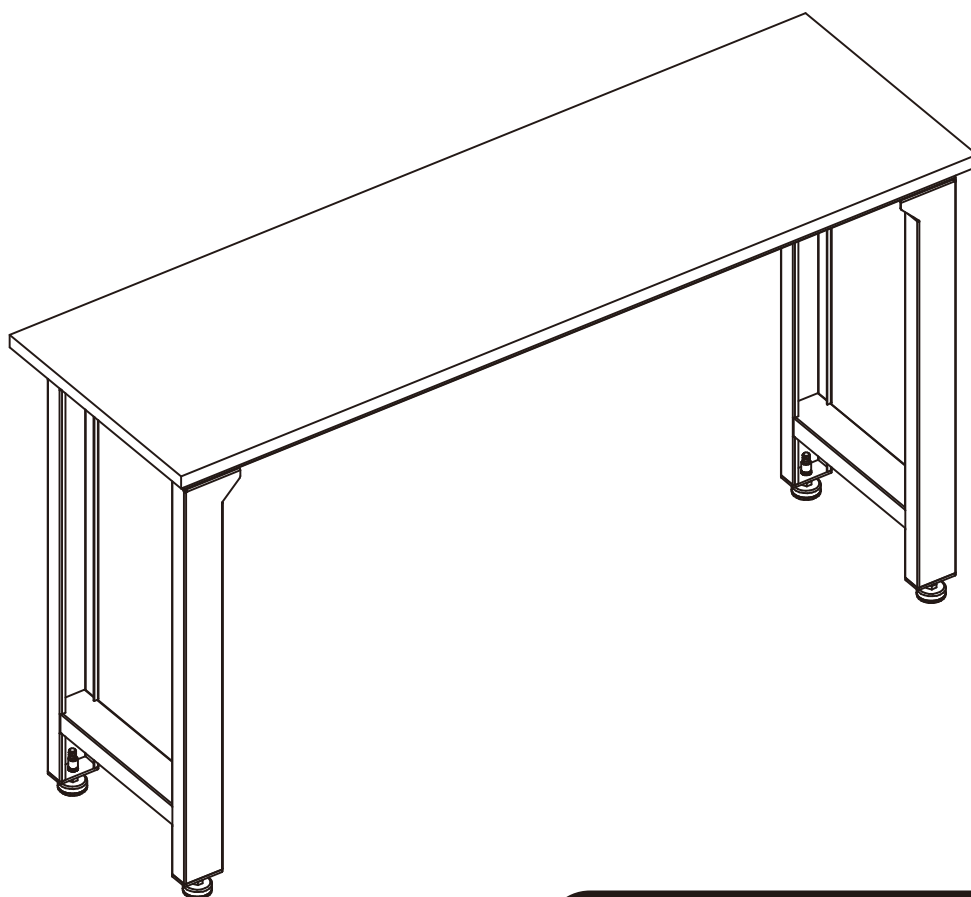

2 PERSONS RECOMMENDED

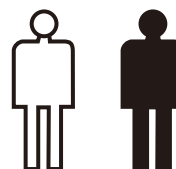

CAUTION:

Read all instructions and safety tips before assembling and using this product.

DIMENSIONS

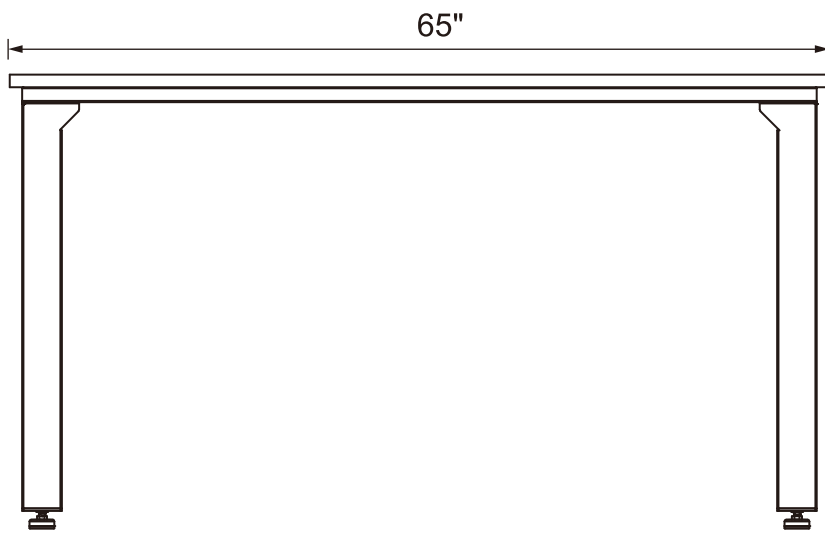

FRONT VIEW

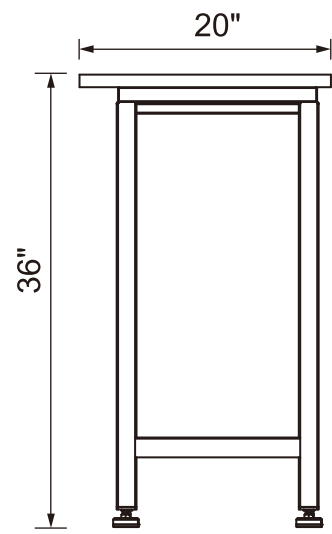

SIDE VIEW

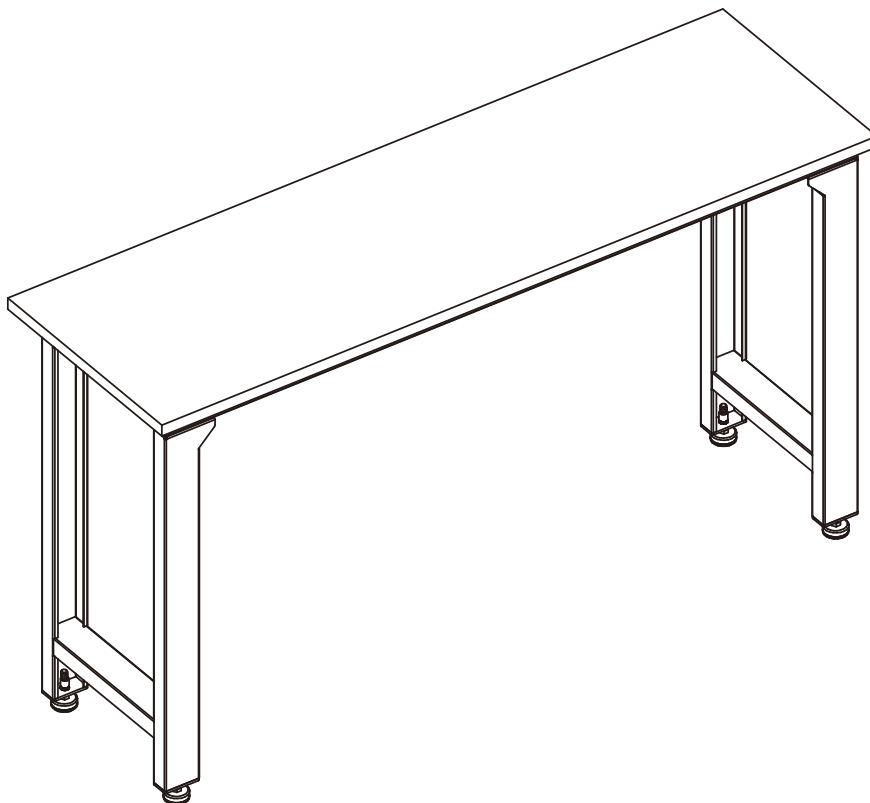

Thank you for selecting the Duracabinet Pro II for your garage storage needs.

The Duracabinet Pro II Garage Storage System was produced with the latest contemporary design, high quality materials and fine workmanship. With proper care and maintenance, it will serve you for many years to come. This installation guide will help you to better understand this product, install it successfully in your home and maintain it to keep it in good condition.

Please exercise proper safety and common-sense measures when installing this product.

Important Note:

1. Before and during installation, please read and familiarize yourself with all installation instructions for this product.
2. Please keep all components, parts and accessories of this product away from small children and minors. During installation, all screws, tools and small parts should be supervised so that they do not fall into the hands of children.
3. Use caution at all times when installing this product. Please ensure that you are physically able to perform all parts of the installation and that you have the correct tools and equipment needed.
4. Before beginning, remove all wrappers and packing materials including staples and packing straps.
5. Please check to ensure that all components and parts are complete.
6. Place all laminated parts on a clean and smooth surface such as carpet or padded flooring to prevent scratching.
7. Some screws and bolts should not be tightened all the way until the entire component or section is aligned in its proper position to allow for adjustments.
8. Please ensure that all drawers and door panels are balanced or level.
9. Clean all parts of the cabinet before use.



WARNING

**This unit is intended for use with the maximum weight indicated. Use of this product exceeding the maximum weight indicated may result in instability and cause injuries. Distribute weight evenly for best results.
(Maximum Load: 1000 lbs total)**

Parts List

ITEM	Description	Qty
WB1	Wooden Table	1
WB2	Table Feet	2

ITEM	Description	Qty
P	Leg Assembly	4
Q	Bolt M8x25mm	8
R	Washer M8	8

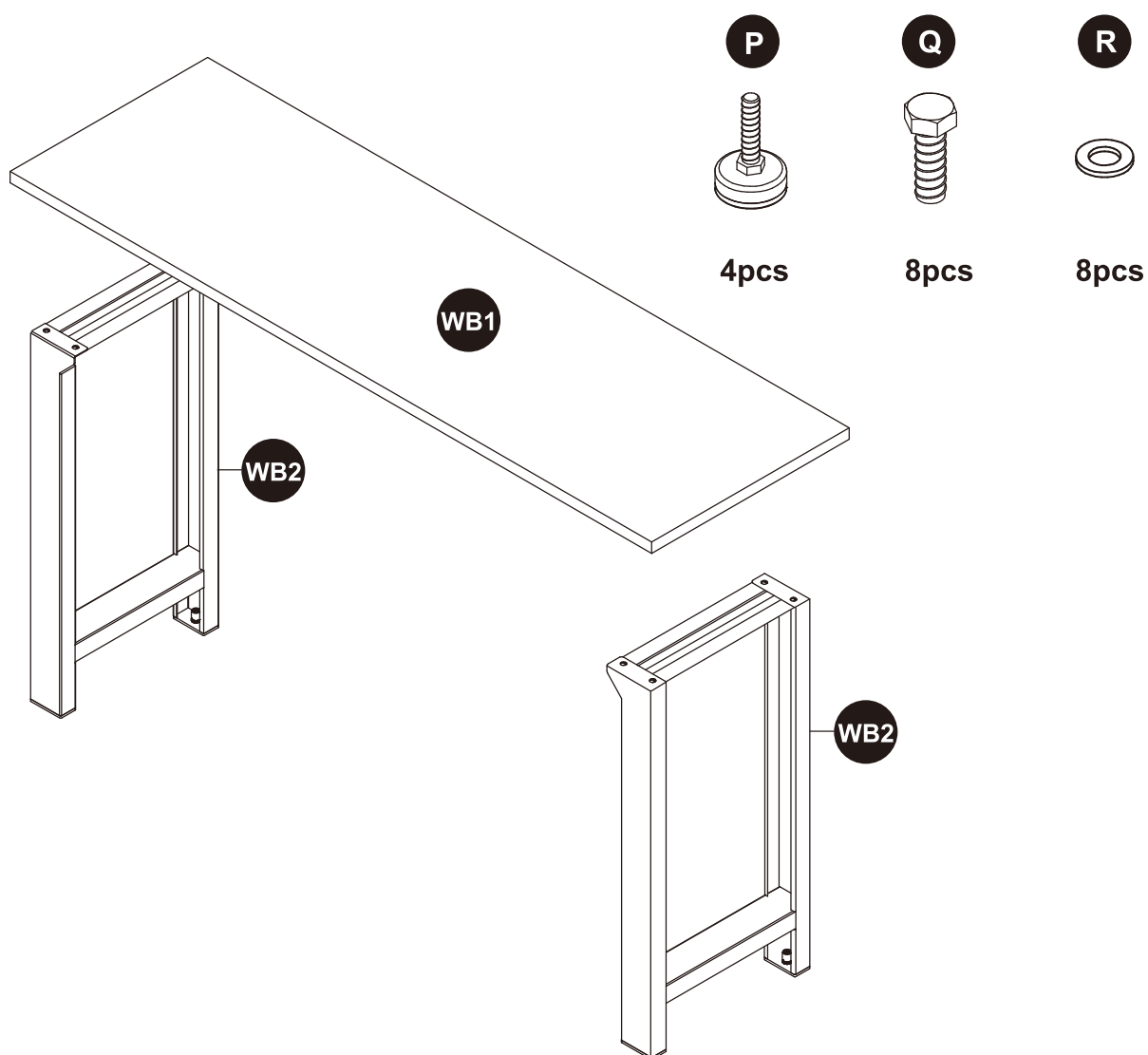

Recommended Tools for Installation

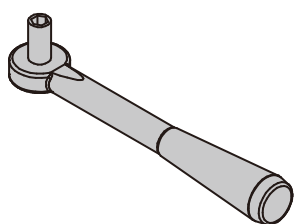

Socket Wrench

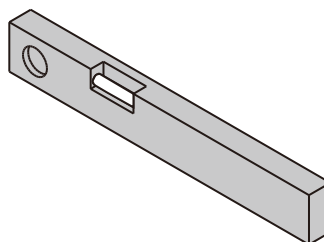

Level

Step1

Table Feet and Screws Assembly

For safe and easy installation, we suggest keeping wooden table (Part #WB1) bottom up in the package while installing the table feet (Part #WB2).

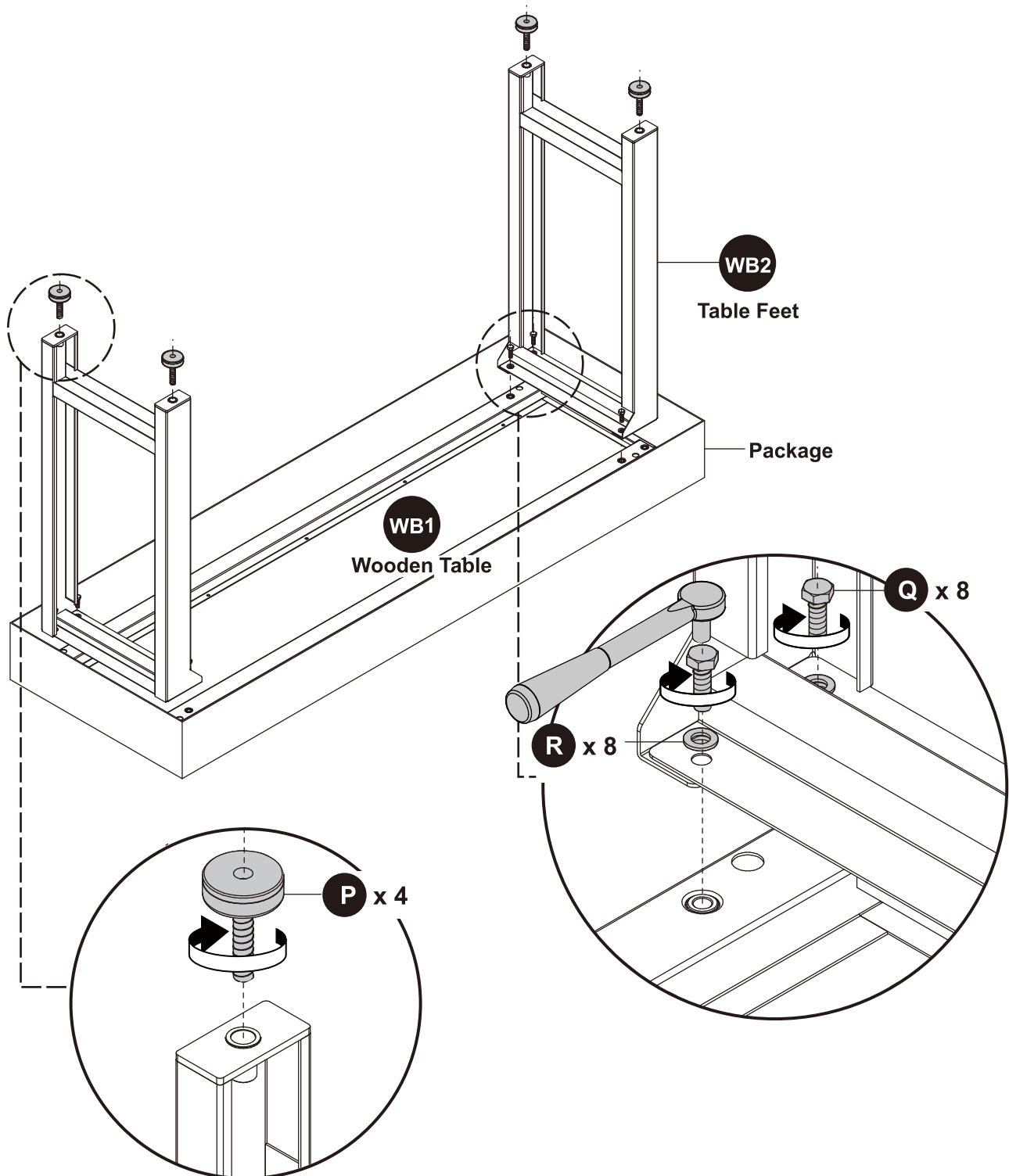

ATTENTION

Follow the diagrams below to check for proper installation.

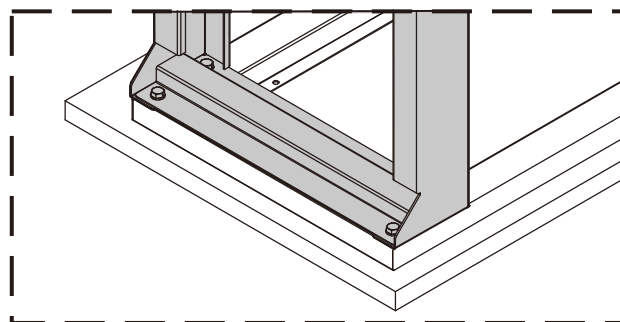
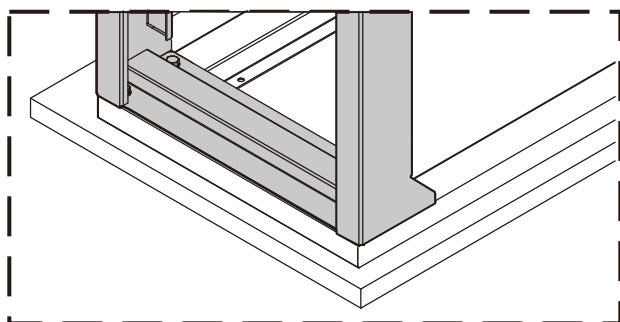
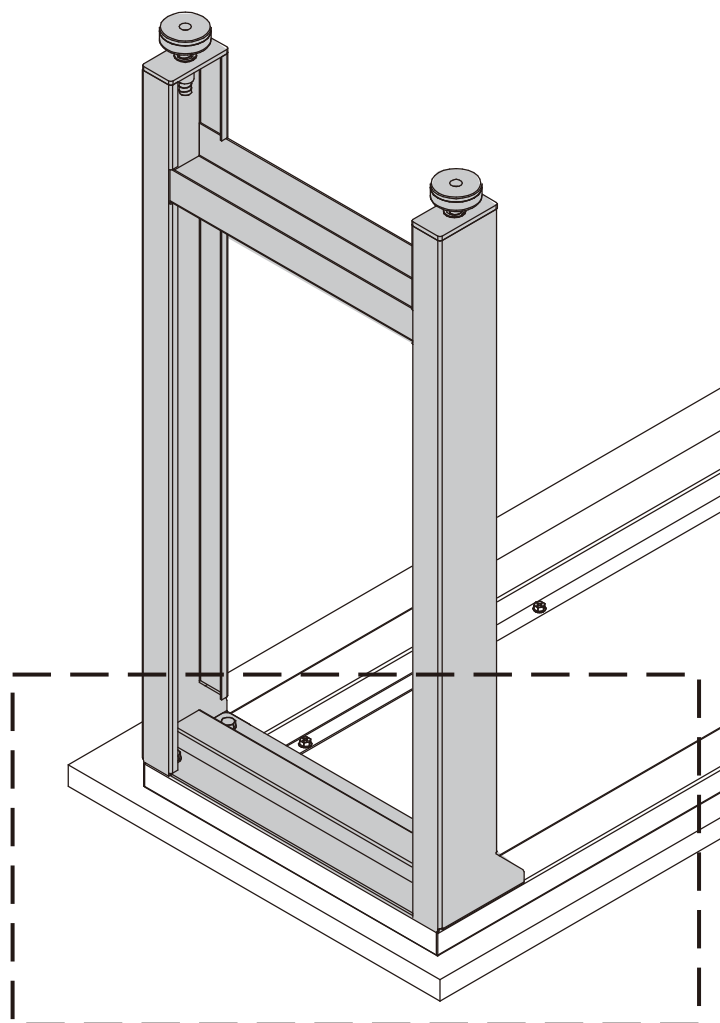

Step2

Horizontal Adjustment

- Once the workbench is fully assembled, turn the workbench around to stand on its legs.
- Use a level to check if work surface is even.
- If workbench is not even, adjust the leg assembly.

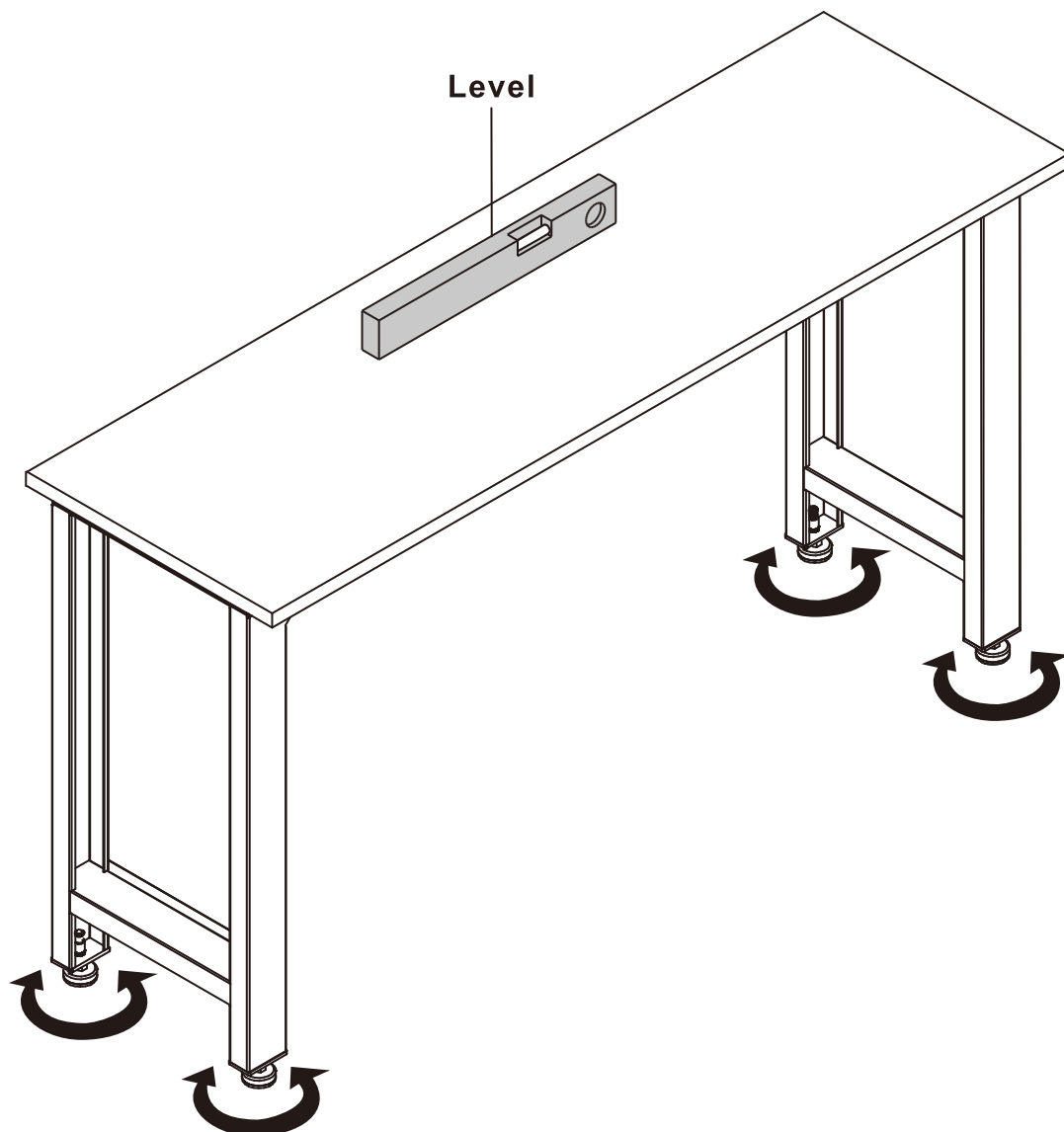



**Have Questions? Need Assistance?
Leave Feedback?**

VALORE USA

Info@ValoreUSA.Com

Hours:

Monday thru Friday
8:30AM-5:30PM(PST)